



acoustic test data

All STS acoustic data is sourced, supplied and verified by independent, UKAS-accredited test facilities in accordance with all relevant British and European standards.

- Approved Document - 'E' (Passage of Sound)
- Approved Document - 'B' (Fire Safety)
- Approved Document - 'M' (Access To and Use of Buildings)
- Building Bulletin - 93 (Acoustic design in schools)*

* See also: "Acoustic Performance Standards for the Priority Schools Building Programme" including: "Technical Guidance Document TGD-021-5 Acoustic Performance in Schools"

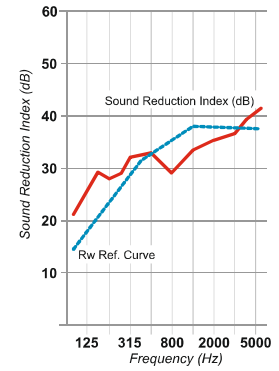

STS 422GT Door-bottom seal

:18

Characteristics / features

Product code	Size / Length	Colour(s)	Performance
STS 422GT - "SIZE" See table below	VARIOUS See table below	N / A	ACOUSTIC - See STS data sheets :01 - :16

Characteristics / features

Protects against / Resists	Fitting / installation	Material(s)
FIRE	See STS data sheet :19	Casing: ALUMINIUM (T60/60)
SMOKE		Seal: NEOPRENE/BUTYL
SOUND		Mechanism: STEEL/NYLON
DRAUGHT		
DUST		
INFESTATION		

Sizes

Product size (pre-cut) mm
430 530 730 930 1130 1330
Product cuts back by (maximum) mm
150 160 200 200 200 200

Adjustment

Uneven Threshold

Left to right

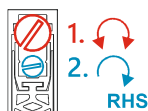
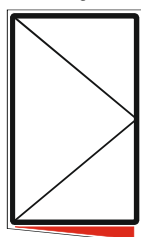

Adjust seal to close gap
Turn for more downward pressure



Right to left

